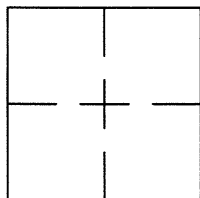

CORNER RECORDDocument Number CR 9780City of OAKLANDCounty of ALAMEDA, CaliforniaBrief Legal Description BRASS DISC MONUMENT LOCATED WITHIN 98TH AVENUE.**CORNER RECORD**Government Corner ☐Meander ☐Rancho ☐Date of Survey 2/14/17Control ☒Property ☐Other ☐**COORDINATES**
(Optional)

N. _____

E. _____

Zone _____ Datum _____

Elev. _____

Corner — Left as found ☒ Found and tagged ☐ Established ☐ Reestablished ☐ Rebuilt ☐

 Identification and type of corner found: Evidence used to identify or procedure used to establish or reestablish the corner:
FOUND BRASS DISC WITH PUNCH, STAMPED RCE 31954, IN MONUMENT WELL LOCATED WITHIN
THE INTERSECTION OF 98TH AVENUE AND ARMSTRONG DRIVE.
THIS POINT WAS REFERENCED PRIOR TO A CONSTRUCTION PROJECT IN THE VICINITY.

 A description of the physical condition of the monument as found and as set or reset: _____
FOUND AND SET POINTS AS SHOWN ON PAGE 2.
THE TIES SHOWN HEREON ARE FOR THE PURPOSE OF PERPETUATING FOUND MONUMENTATION.
NO CLAIM IS MADE AS TO THE RELATIONSHIP OF THE POINTS OR LINES SHOWN HEREON TO
TRUE BOUNDARY LOCATIONS.
SURVEYOR'S STATEMENT
 This Corner Record was prepared by me or under my direction in conformance with
 the Land Surveyors' Act on MARCH 1, 2017.

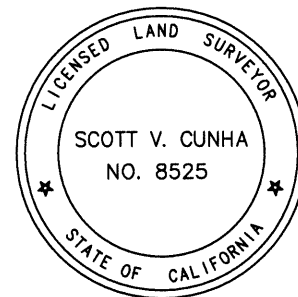
 Signed Scott V. Cunha L.S. Number LS 8525
SCOTT V. CUNHA
**COUNTY SURVEYOR'S STATEMENT**
 This Corner Record was received 20 MARCH 2017 and examined
 and filed 7 JUNE 2017.

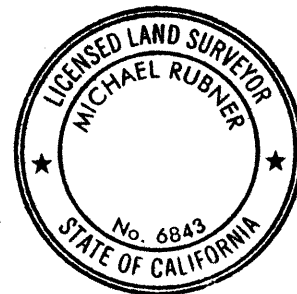
 Signed Michael Rubner Title COUNTY SURVEYOR

County Surveyor's Comment _____

LEGEND

- ARMSTRONG
DR.

9679

98TH AVE.

GOULD
ST.

63°1'25"

45.28

64.42"

49.07

66.70'

116°58'35"

63° 1' 25"

176°58'35"

1008

1004

1000

217016-98TH-CR04