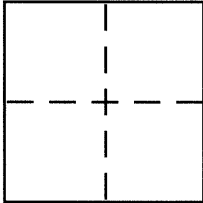

**CORNER RECORD**Document Number CR 9040City of San Leandro County of Alameda, CaliforniaBrief Legal Description Monuments C Orchid Dr & 143rd Ave**CORNER TYPE**

Government Corner ☐ Control ☒  
 Meander ☐ Property ☐  
 Rancho ☐ Other ☐  
 Date of Survey 9-30-16

**COORDINATES (Optional)**

N. \_\_\_\_\_  
 E. \_\_\_\_\_  
 Zone \_\_\_\_\_ NAD27 ☐ NAD83 ☐  
 NAD83 Epoch \_\_\_\_\_  
 Elev. \_\_\_\_\_  
 Vert. Datum: NGVD29 ☐ NAVD88 ☐  
 Meas. Units: Metric ☐ Imperial ☒

Corner - Left as found ☒ Found and tagged ☐ Established ☐ Reestablished ☐ Rebuilt ☐

Identification and type of corner found: Evidence used to identify or procedure used to establish or reestablish the corner:

Per section 8771b of the Business and  
professions code  
This monument was referenced prior after a  
construction project in the vicinity  
Reference "Prior Construction" CR 8129 pt 77/85

A description of the physical condition of the monument as found and as set or reset:

Found in good condition

**SURVEYOR'S STATEMENT**

This Corner Record was prepared by me or under my direction in conformance with  
 the Land Surveyor's Act on 10/7/2016

Signed Joseph Pruefer P.L.S. or R.C.E. No. 5254

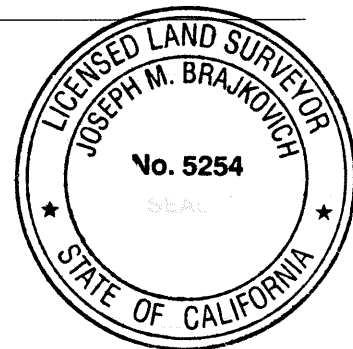
**COUNTY SURVEYOR'S STATEMENT**

This Corner Record was received 6 OCTOBER, 2016

and examined and filed 31 OCTOBER, 2016

Signed Michael Rubner P.L.S. or R.C.E. No. 6843

Title COUNTY SURVEYOR

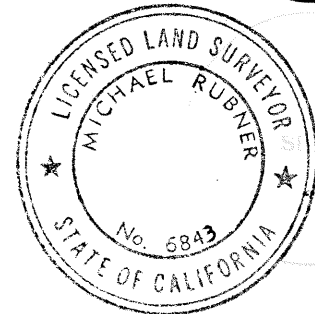

County Surveyor's Comment \_\_\_\_\_

REF.  
NORTH  
1"=10'

MONUMENT

45.02  
N46°31'10"W

33.66  
N19°35'34"W

MONUMENT

**BD 21F4**

40.05  
S81°36'26"W

44.03  
N75°47'59"E

143RD AVENUE

ORCHID DRIVE

LEGEND

● MONUMENT

○ CUT X