

OUTSIDE CORNER DETAIL

3

Scale= 3" = 1'-0"

A-104

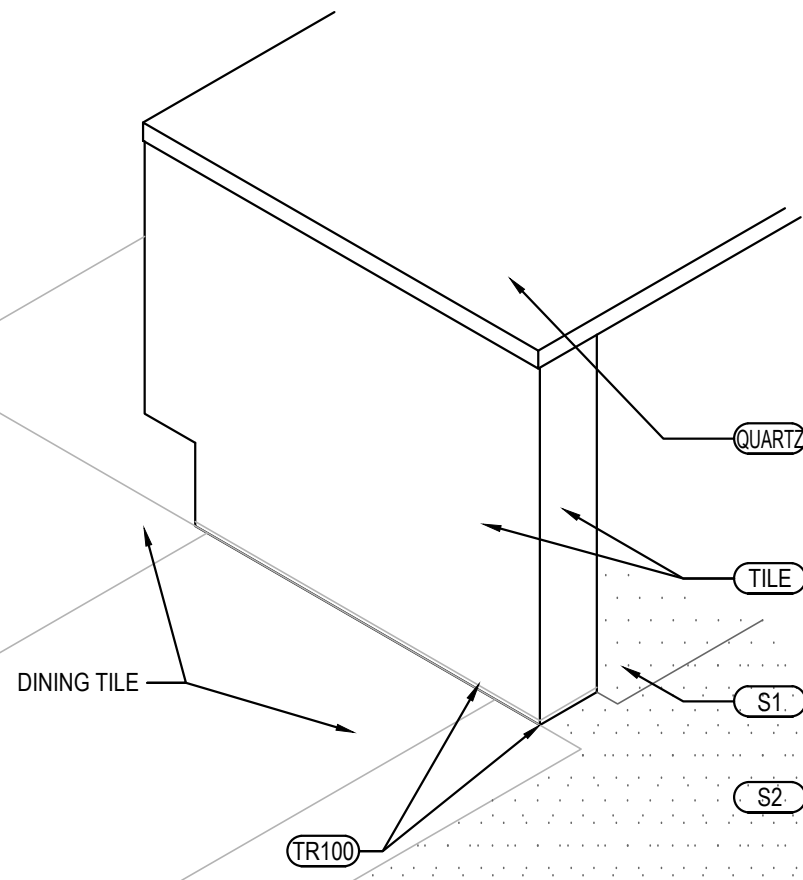

SERVICE COUNTER ISOMETRIC

2

Scale= 3/4" = 1'-0"

A-104

TILE SCHEDULE

INSTALLED AND FURNISHED BY G.C. UNLESS NOTED OTHERWISE

01-11-19

| NO. | MANUFACTURER | DESCRIPTION | COLOR | FINISH | JOINT | GROUT | REMARK |
|---------|--|------------------------------------|--------------------------------|-----------------|---------------------------------|--|---|
| (T-108) | CMC AGGREGATE DOUG SALATINO 518-713-5371 | 12" X 24" X 3/8" | - | - | 1 / 8" | G-111 | RESTROOM WALL |
| (T-110) | DALTILE | 6" X 36" X 3/8" 9" X 36" X 3/8" | FOREST PARK TIMBERLAND FP97 | - | 1 / 8" | G-113 | RR VESTIBULE & DINING ROOM WALLS CONTACT: NATIONAL ACCOUNT SUPPORT DESK 877.556.5728 (national.accounts@daltile.com) |
| (T-200) | CMC DOUG SALATINO 518-713-5371 | 24" X 24" | BRAVADA GREIGE | MATTE | 1/8" | G-96 | DINING & RESTROOM FLOOR |
| (T-300) | EMSER - ECHO | 3" HEXAGON | CALACATTA | MATTE | 1/8" | G-114 | BEVERAGE COUNTER BACKSPASH AND SERVICE COUNTER |
| (S1) | SILIKAL | QUARTZ BLEND #4 | - | PLAIN | - | - | KITCHEN, SERVICE FLOOR CONTACT: MARK FELDMAN 770-830-1404 (info@feldman@silikalamerica.com) JOHN COOTHRAN 888-830-1404 (jcoothran@silikalamerica.com) |
| (S2) | SILIKAL | QUARTZ BLEND #4 | - | ABRASIVE | - | - | (2) 2' X 6' PIECES FOR 4' X 6' OVERALL MAT SIZE IN VESTIBULE @ VESTIBULE STORES |
| (M100) | MATSINC 800.628.7462 | NUWAY - 7/16" ALUM FOOT GRILLE | CHARCOAL | - | - | - | |
| GROUT | MANUFACTURER | DESCRIPTION | MFG. | COLOR | FINISH | REMARK | |
| (G-96) | MAPEI 800.42.MAPEI WWW.MAPEI.COM | LATEX MODIFIED GROUT | 11 | SAHARA BEIGE | POLY BLEND 1 / 8" NON-SANDED | DINING & RESTROOM FLOOR APPLY GROUT SEALER | |
| (G-111) | MAPEI 800.42.MAPEI WWW.MAPEI.COM | LATEX MODIFIED GROUT | 19 | PEARL GREY | POLY BLEND 1 / 8" NON-SANDED | RESTROOM, DINING APPLY GROUT SEALER | |
| (G-113) | MAPEI 800.42.MAPEI WWW.MAPEI.COM | LATEX MODIFIED GROUT | 07 | CHOCOLATE | POLY BLEND 1 / 8" NON-SANDED | APPLY GROUT SEALER | |
| (G-114) | CUSTOM BUILDING PRODUCTS | PRISM GROUT | 11 | SNOW WHITE | POLY BLEND 1 / 8" NON-SANDED | BEVERAGE COUNTER BACKSPASH APPLY GROUT SEALER | |

* REFER A-200 EXTERIOR FINISH SCHEDULE FOR EXTERIOR DECORATIVE TILE

* SCHLUTER SYSTEM ALUMINUM TRIM:

COVE TILE TRIM: INSTALLED AT RESTROOM, SERVICE COUNTER, AND DRINK STATION
SCHLUTER SYSTEMS DILEX-AHK 1S 125 ATGB (BRUSHED NICKEL ANODIZED ALUMINUM)
-OUTSIDE CORNER CONNECTOR PIECE: DILEX-AHK-E90/AHK 1S 125 ATGB (BRUSHED
NICKEL ANODIZED ALUMINUM)
-INSIDE CORNER CONNECTOR PIECE: DILEX-AHK-I90/AHK 1S 125 ATGB (BRUSHED
NICKEL ANODIZED ALUMINUM)
-END CAP PIECE: DILEX-AHK-E/AHK 1S 125 ATGB (BRUSHED NICKEL ANODIZED
ALUMINUM)

EDGE TILE TRIM:
SCHLUTER SYSTEMS RONDEC-RO125 ATGB (BRUSHED NICKEL ANODIZED ALUMINUM)
(TR101) -OUTSIDE CORNER CONNECTOR PIECE: RONDEC-EV/RO125 ATGB (BRUSHED NICKEL
ANODIZED ALUMINUM)
-INSIDE CORNER CONNECTOR PIECE: RONDEC-IL/RO125 ATGB (BRUSHED NICKEL
ANODIZED ALUMINUM)

* EPOXY GROUT BY MAPEI, KERAPoxy IEG, 100% SOLIDS INDUSTRIAL GRADE:
AREAS: UNDER HOOD AND 36" IN FRONT OF COOKING LINE, 3 COMPARTMENT SINK AND MOP SINK AREA
SEE MANUFACTURER'S SPECIFICATION, DETAILS AND GUIDE FOR PREPARATION,
MIXING, GROUTING AND CLEANING INSTRUCTION
NOTE: SEE INTERIOR SHEETS FOR WALL/ BASE TILE LOCATIONS AND
SPECIFICATIONS

FLOOR TILE TRANSITION TRIM: INSTALLED IN VESTIBULE
SCHLUTER SYSTEMS SCHIENE-RIA125 (SATIN ANODIZED ALUMINUM)
(TR102)

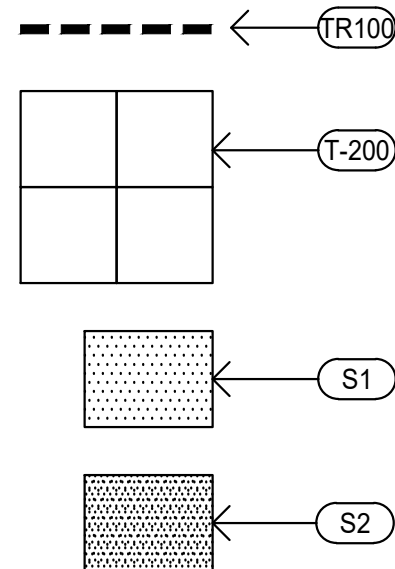

FINISH SCHEDULE

A

Scale= NTS

A-104

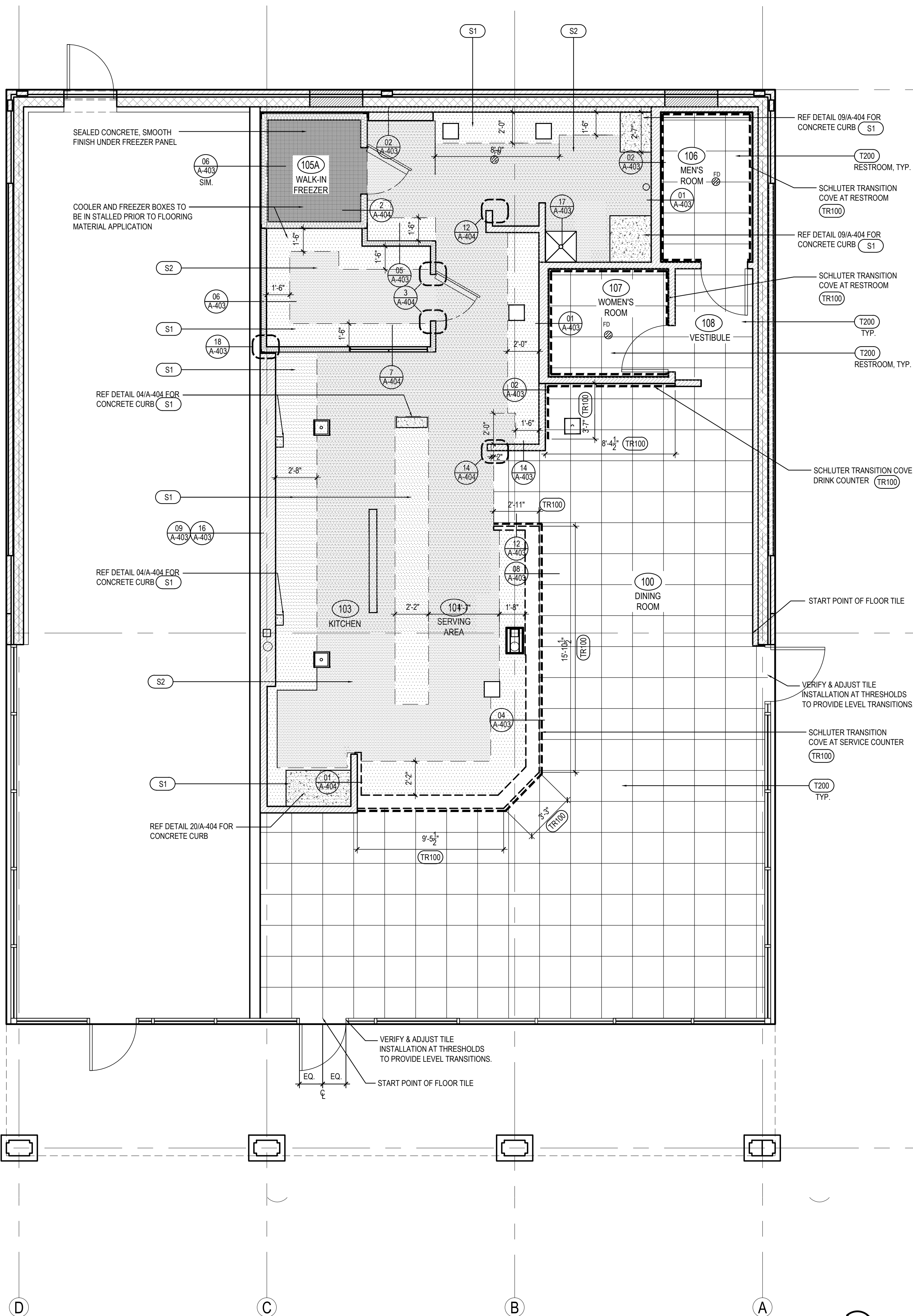

FINISH PLAN

1

Scale= 1/4" = 1'-0"

A-104



PANDA EXPRESS, INC.
1683 Walnut Grove Ave.
Rosemead, California
91770

Telephone: 626.799.9898
Facsimile: 626.372.8288

All ideas, designs, arrangement and plans indicated or
represented by this drawing are the property of Panda
Express Inc. and were created for use on this specific project.
None of these ideas, designs, arrangements or plans may be
used by or disclosed to any person, firm, or corporation
without the written permission of Panda Express Inc.

REVISIONS:

ISSUE DATE:

| | |
|-----------------|------------|
| PEER REVIEW | 01-27-2020 |
| PR RESPONSE 1 | 02-21-2020 |
| BUILDING PERMIT | 03-11-2020 |

DRAWN BY: CSW

PANDA PROJECT #: D7446

ARCH PROJECT #: JCDT19-0314

NORR
ARCHITECTS ENGINEERS PLANNERS

PANDA EXPRESS

GREENBRIAR TOWN CENTER,
13059 LEE JACKSON MEMORIAL HWY
FAIRFAX, VA 22033

A-104

FINISH PLAN AND SCHEDULE