

RECORD of SURVEY BOUNDARY LINE ADJUSTMENT

NOTES and LEGEND

- DENOTES 3/4" REBAR WITH PLASTIC CAP STAMPED PLS 3570 SET ON THIS SURVEY
- DENOTES CONCRETE NAIL WITH TAG PLS 3570 SET ON THIS SURVEY
- DENOTES FOUND 3/4" REBAR WITH ALUMINUM CAP STAMPED "1981 RCE 30341" PER 48-M-99
- DENOTES FOUND NAIL AND SHINER TAGGED LS 3725
- DENOTES A CALCULATED POINT ONLY, NOTHING FOUND OR SET
- () DENOTES RECORD DATA PER 48-M-99
- (()) DENOTES RECORD DATA PER 1-M-51
- ((()) DENOTES RECORD DATA PER 20140001582
- PUE DENOTES PUBLIC UTILITY EASEMENT

BASIS OF BEARINGS IS REFERRED TO A TIE BETWEEN FOUND MONUMENTS AS SHOWN ON 48-M-99, THE BEARING OF WHICH IS N 06°25'48" W.

for
DOUGLAS HILL
20140001582

BEING AN ADJUSTMENT OF LOTS 13 AND 14, BLOCK 2
ALSO BEING A PORTION OF THE NW 1/4 SECTION 11, T. 7 N., R. 10 E., M. D. M.
CITY OF PLYMOUTH, COUNTY OF AMADOR, STATE OF CALIFORNIA

June, 2018

TOMA & ASSOCIATES INC.
ENGINEERING - SURVEYING - PLANNING
41 Summit Street, Jackson, CA 95642
(209) 223-0156

Scale: 1" = 20'

SURVEYOR'S STATEMENT

THIS MAP CORRECTLY REPRESENTS A SURVEY MADE BY ME OR UNDER MY DIRECTION IN CONFORMANCE WITH THE REQUIREMENTS OF THE PROFESSIONAL LAND SURVEYORS ACT AT THE REQUEST OF DOUGLAS HILL IN JANUARY OF 2018.

DATE: June 13, 2018

Ciro L. Toma
CIRO L. TOMA P.L.S. 3570
MY LICENSE EXPIRES 6-30-2020

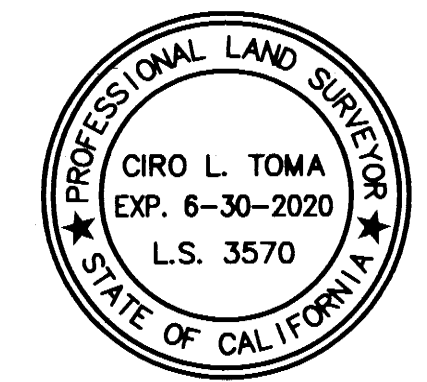

COUNTY SURVEYOR'S STATEMENT

THIS MAP HAS BEEN EXAMINED IN ACCORDANCE WITH SECTION 8766 OF THE PROFESSIONAL LAND SURVEYORS ACT THIS 22nd DAY OF June, 2018.

Steven A. Zanetta
STEVEN A. ZANETTA PLS 6245
AMADOR COUNTY SURVEYOR
MY LICENSE EXPIRES 3-31-2020

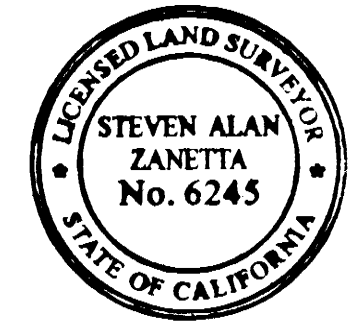

CITY CERTIFICATION

THE BOUNDARY LINE ADJUSTMENT SET FORTH HEREON WAS APPROVED IN ACCORDANCE WITH CITY CODE CHAPTER 16.28, "LOT LINE ADJUSTMENTS", BY THE CITY COUNCIL OF THE CITY OF PLYMOUTH ON APRIL 12, 2018 BY RESOLUTION 2018-12.

DATE: 6/13/2018

Roark Weber
ROARK WEBER R.C.E. 22295
ASSOCIATE PLYMOUTH CITY ENGINEER
MY LICENSE EXPIRES 9-30-2019



RECORDER'S STATEMENT

FILED THIS 26th DAY OF June, 2018 AT 2:32 P.M.
IN BOOK 65 OF MAPS AND PLATS AT PAGE 68 AT THE REQUEST OF
THE AMADOR COUNTY SURVEYOR.

FEE: \$10.00 pd/filed

INSTRUMENT No.: 2018-0004755

Kimberly L. Grady
KIMBERLY L. GRADY
AMADOR COUNTY RECORDER

BY: *V. Gutado*
DEPUTY

OWNER'S STATEMENT

THE UNDERSIGNED, BEING THE OWNER OF THE PROPERTY DELINEATED HEREON, DOES HEREBY CONSENT TO THE PREPARATION AND RECORDATION OF THIS MAP.

Douglas Hill
DOUGLAS HILL

